

CLIMA HOSTELERÍA



- Product Code: EMP.PLS.7FE010

- Stainless steel baskets
- Movable heaters provide easy cleaning
- Safe oil drain with drain cock.
- Limit thermostat.
- Easy to clean and hygienic.
- Stainless steel body.

Fryer chamber is monoblock pressed and corners are rounded.

Chamber capacity is 16 liters.

- There is a safety thermostat to prevent the oil from overheating.

- There are two baskets in each chamber as standard.

Front

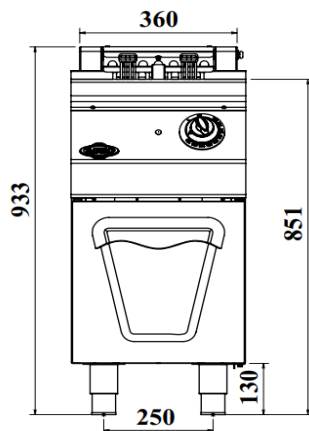

Side

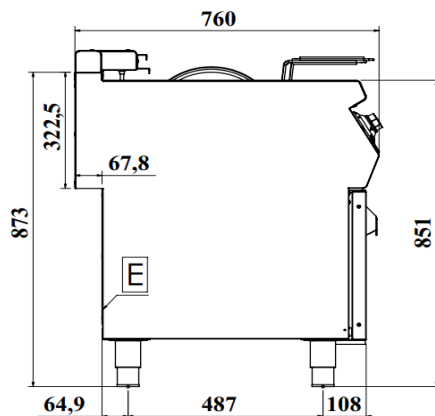

Back

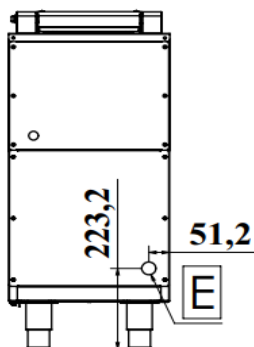

Electric Inlet

Installation Information

Total power	10,5 kW
Electric Inlet	400 V. AC 3N PE
Cable cross section	5 x 2,5

Main Information

Lenght	400 mm
Depth	760 mm
Height	316 mm
Weight	27 kg
m ³	0.11,5

Packed Lenght	480 mm
Packed Depth	860 mm
Packed Height	620 mm
Packed Weight	36 kg

capacity	16 Litre
----------	----------